

060966000



Becker County Planning & Zoning  
915 Lake Ave  
Detroit Lakes, MN 56501  
(218) 846-7314  
www.co.becker.mn.us

## Certificate of Compliance Inspection Report - Permit #: SS2019-115

### Owner & Property Information

<b>Owner Name:</b>	RANDY J & WENDY L IWERKS	<b>Site Address:</b>	XXXXX Nels Erickson LN
<b>Mailing Address:</b>	RANDY J & WENDY L IWERKS 16596 SECLUSION PT RD AUDUBON MN 56511	<b>Township - Sec/Twp/Rng:</b>	CORMORANT - 24/138/043
<b>Parcel #:</b>	060966000	<b>Legal Description:</b>	POINTE DES ISLES PT LOTS 1, 2 POINTE DES ISLES: COMM NLY COR LOT 3 SE OF NELS ERICKSON LN,, NE 24.43', NE 43.72' TO POB; NE 243.85' TO BIG CORM LK, NWLY & SELY AL LK TO NE LN LOT 3, SE 98.44', NE 70.93' TO POB.
<b>Secondary Parcel #:</b>		<b>Designer:</b>	Scott's Septic Services LLC, L3947 (Scott Ellingson)
		<b>Installer:</b>	Sonnenberg Excavating LLC, L2315 (Torey Sonnenberg)

### Inspector Verified Specifications

<b>Insp- Effluent Screen Installed:</b>	No	<b>Insp- Tank Nbr/Size:</b>	2/1500/2 septic and 500 lift
<b>Insp- Alarm Required:</b>	Yes	<b>Insp- Drainfield Type:</b>	Pressure Bed
<b>Insp- Lift Pump in System:</b>	Yes	<b>Insp- Drainfield Size:</b>	396
<b>Insp- Number of Bedrooms:</b>	3	<b>Insp- Soil Verification:</b>	#1:84" (in tank hole) see attached Restrictive Layer Verification #2:N/A #3:N/A

### Inspector Verified Setbacks

<b>Insp- Tank Dist to Road</b>	100's	<b>Insp- Drainfield Dist to Road</b>	100's
<b>Insp- Tank Dist to Nearest Prop Line</b>	100+ ( lot line per installer)	<b>Insp- Drainfield Dist to Nearest Prop Line</b>	100+ (lot line per installer)
<b>Insp- Tank Dist to Nearest Structure</b>	25	<b>Insp- Drainfield Dist to Nearest Structure</b>	50
<b>Insp- Tank Dist to Well</b>	125+	<b>Insp- Drainfield Dist to Well</b>	130+
<b>Insp- Tank Dist to OHW</b>	75+	<b>Insp- Drainfield Dist to OHW</b>	75+
<b>Insp- Tank Dist to Pond/Wetland</b>	n/a	<b>Insp- Drainfield Dist to Pond/Wetland</b>	n/a
<b>Insp- Tank Dist to Pressure Line</b>	50+	<b>Insp- Drainfield Dist to Pressure Line</b>	50+

### Certificate of Compliance

(Yes) Certificate is hereby granted based upon the application, addendum from, plans, specifications and all other supporting data. With proper maintenance, this system can be expected to function satisfactory, however this is not a guarantee.

Zoning Office Signature:

Certification Date: 7/17/2019

Denise Gubrud

Denise Gubrud - ISTS Inspector

\* Certificate of Compliance is not valid unless signed by a Registered Qualified Employee \*

# Field Review Form

Permit # SS2019-115

## Property and Owner

Owner: <b>RANDY J &amp; WENDY L IWERKS</b>	Parcel Number: <b>060966000</b>
Site Address: <b>XXXXX Nels Erickson LN</b>	Secondary Parcel:

## Home Information

Does the structure contain any of the following elements?	Designer submitted	Inspector verified
	Garbage disposal: No Dishwasher: Yes Grinder pump: Yes Lift pump in bsmt: No	Garbage disposal? Y (N) Dishwasher? (Y) N Grinder pump? (Y) (N) Lift pump in basement? (N) (N)
Number of bedrooms: <b>3</b>	Review - Number of bedrooms: <b>3</b>	
Effluent screen	Effluent screen installed? Y (N) Mfr:	
Alarm: <b>Yes</b> Type: <b>Electric</b>	Review - Alarm? (Y) N Type & Mfr:	
Lift pump in system: <b>Yes</b>	Review - Lift pump in system? (Y) N Mfr:	

## Component Information

Tank size: <b>1500-2 Septic / 625 Lift</b>	Review - Tank nbr: <b>2</b> size: <b>1500/2</b> Mfr: <b>Infiltrator</b>
Drainfield type: <b>Pressure Bed</b>	Review - Drainfield type: <b>Pressure bed</b>
Drainfield size: Full size - <b>396</b> Reduced/warr. size -	Review - Drainfield status: none / installed / next spring Review - Drainfield size:
Absorption area size: <b>NA</b>	Review - Absorption area size: <b>9 x 44</b>
Chamber type/num: <b>Quick 4 Low Pro's 33</b> Trench sqft/chamber - <b>12</b>	Review - Chamber type: <b>Low profile</b> Num: <b>33</b> Review - Trench sqft/chamber: <b>12</b>
Drainfield rock depth: <b>NA</b>	Review - Rock depth:

## Soil Verification

Vertical separation verified	Boring #1: Boring #2: Boring #3:
------------------------------	--

## Setback Verification

Distance to...	Designer submitted		Inspector verified	
	Tank	Drainfield	Tank	Drainfield
Road	100+	100+	100's	100's
Nearest prop line	100+	100+	100'	100'
Nearest structure	10'	20'	25'	50'
Well	50+	50+	125'	130'
OHW	85'	75'	75'	75'
Pond/Wetland	NA	NA		
Pressure line	10+	10+	20'	20'

Date System Installed: **7/17/19** Installer: **Dusty Sonnenberg's** Inspector: **DeWise Gubrun**

C 8952

## Becker County Restrictive Layer Verification

Client: Randy Jverts Parcel: 060960000 Date: 7-17-19

Address: Nels Erickson Lane

Vegetation: bush

Weather Conditions/Time of Day: Sunny 3:00pm Observation#/Location/Method: pit (tank hole)

Depth (in)	Texture	Matrix Color(s)	Mottle Color(s)
84"	Sand	10 yr 5/4	none

Comments/Notes:

there are a few, softball size pockets of clay - not red, not cherting

**Certified Statement:** I hereby certify that I have completed this work in accordance with all applicable ordinance, rules and laws.

(Designer) <u>Scott Ellingsen</u>	(Inspector) <u>Dennis Gubrud</u>	(License #) <u>C8952</u>	(Date) <u>7-17-19</u>
--------------------------------------	-------------------------------------	-----------------------------	--------------------------

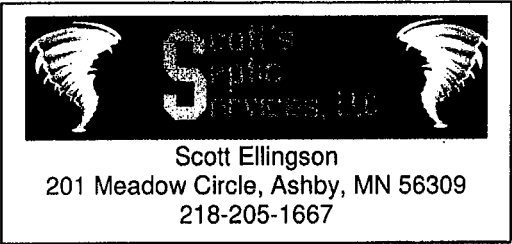

7-17-19  
 certify (sense)  
 Parcel # 060960000 (gabriel)

YEAR 2019  
 SCALE 1" = 40' 6-25-19

LAKE  
**SKETCH OF PROPERTY**

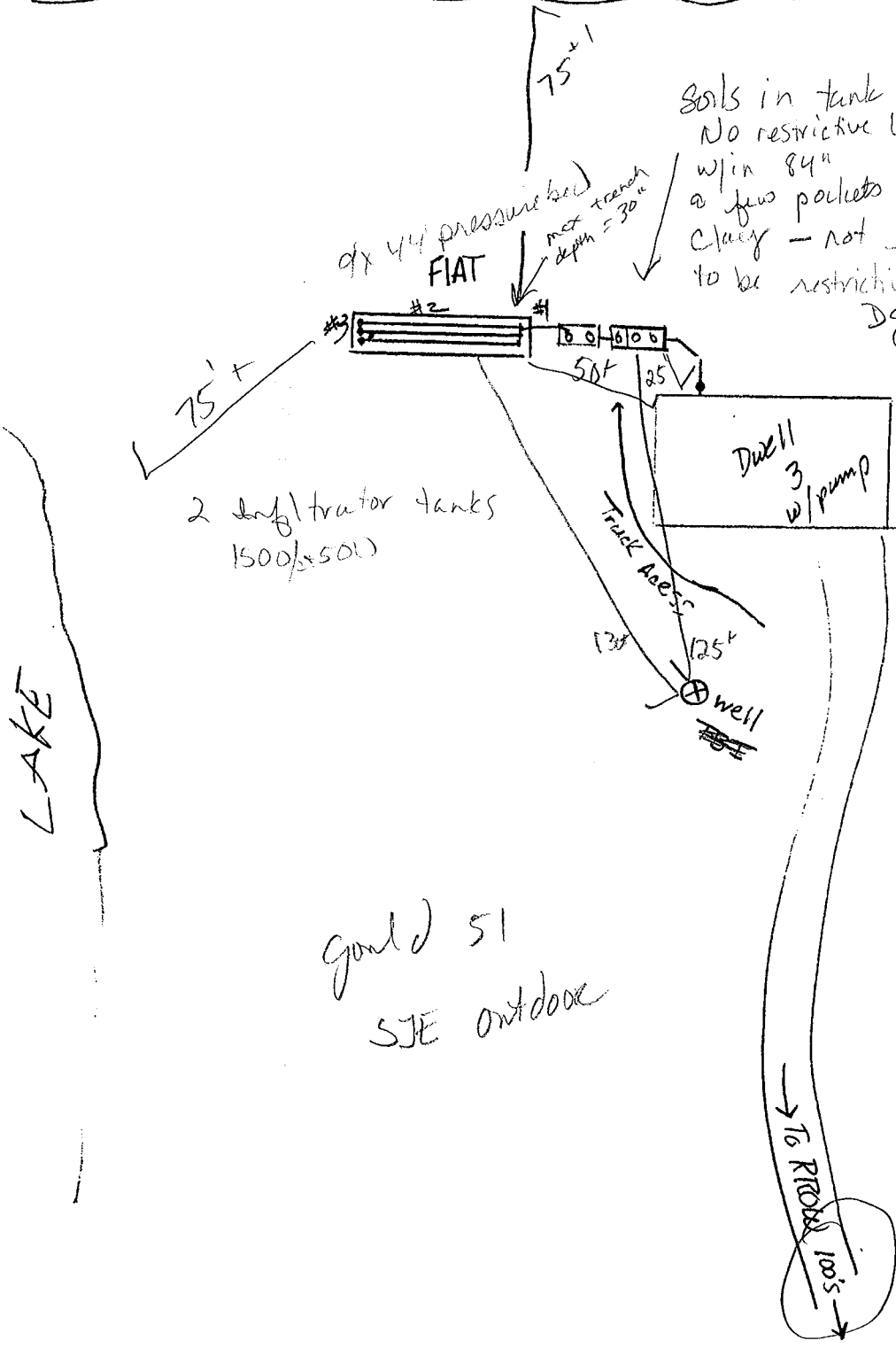

Soils in tank hole  
 No restrictive layer  
 w/in 84"  
 a few pockets of clay - not enough to be restrictive  
 3 beds  
 No Garbage  
 yes pump  
 1500-2 Septic  
 5000 Lift  
 Type 1 Pressure bed  
 9'x44' Chamber bed  
 33 LP's 39.0'

- ✓ 2" Supply line
- ✓ 2" Laterals
- ✓ 3' holes apart
- ✓ 1/4" holes
- 34 gpm
- 13.9 fflh
- 84" to Limiting layer
- 48" MAX Bed Depth

Inches per dose 6.5"  
 Alarm Depth 26.5"  
 pump on 24.5"  
 pump off 18"

gould 51  
 SJE outdoor

Lot Line



Becker County Planning & Zoning  
 915 Lake Ave  
 Detroit Lakes, MN 56501  
 (218) 846-7314  
 www.co.becker.mn.us

7-17-2019

3:00

# Septic Permit

Permit #: SS2019-115

(Dusty) Sonnenberg

## Owner & Property Information

Owner Name:	RANDY J & WENDY L IWERKS	Parcel #:	060966000
Mailing Address:	RANDY J & WENDY L IWERKS 16596 SECLUSION PT RD AUDUBON MN 56511	Secondary Parcel #:	
Phone #:	218-85-7046	Site Address:	XXXXX Nels Erickson LN
Lake/River(1000 /300):	Yes	Township - Sec/Twp/Rng:	CORMORANT - 24/138/043
Lake/River Name:	Big Cormorant (Lake Eunice & Cormorant) [RD] NA	Designer:	Scott's Septic Services LLC, L3947 (Scott Ellingson)
Pond/Wetland(50):	No	Installer:	Sonnenberg Excavating LLC, L2315 (Torey Sonnenberg)

## Specifications

Tank to be Installed:	Compartmented Tank	Type of Drainfield:	Pressure Bed
Total # Tanks Installed:	2	Full Size of Drainfield:	396
System Status:	No Existing System	Reduced/Warrantied Size:	
System Serves:	Dwelling	Absorbtion Area Size:	9' X 44"
Number of Bedrooms:	3	Rock Depth:	NA
Design Flow/GPD:	450	Chamber Type and Number:	Quick 4 Low Pro's 33
Garbage Disposal?	No	Chamber Trench SqFt/Chamber:	12
Size of Lift Pump:	34 gpm / 13.9 tfh	Is System Pressurized?	Yes
Size of Lift Line:	2"	Alarm?	Yes
Soil Sizing Factor:	.83	Type of Alarm:	Electric

## Setbacks

Road Type:	Public / Township	Right of Way Marked:	No
Tank Dist to Road:	100+	Drainfield Dist to Road:	100+
Tank Dist to Closest Prop Line:	100+	Drainfield Dist to Closest Prop Line:	100+
Tank Dist to Nearest Structure:	10'	Drainfield Dist to Nearest Structure:	20'
Tank Dist to Well:	50+	Drainfield Dist to Well:	50+
Tank Dist to OHW:	85	Drainfield Dist to OHW:	75
Tank Dist to Pond/Wetland:	NA	Drainfield Dist to Pond/Wetland:	NA
Tank Dist to Pressure Line:	10+	Drainfield Dist to Pressure Line:	10+

## Other Information

Date Approved:	6/25/2019
Permit Fee:	225.00
Receipt Number:	247822144
Date Paid:	6/25/2019
Notes: 1500/2 septic tank, 625 lift tank 9' X 44' pressure bed, 3 laterals 2" laterals, 1/4" perfs, 3' spacing Pump 34 gpm 13.9 tdh 84" to restrictive layer, 48" maximum depth of bed	

Zoning Office Signature:

Denise Gubrud

PERMIT MUST BE POSTED AT JOB SITE. PERMIT EXPIRES ONE YEAR FROM DATE PAID.  
 \*\* Please schedule for inspection prior to installation! \*\*